

CÓDIGO - MP 06903300029
 CÓDIGO - PA 33166410000

	② TEMP. AT 700mm Hg (°C)		TEMP. AT 760mm Hg (°C)	
	WARM / QUENTE	COLD / FRIJO	WARM / QUENTE	COLD / FRIJO
CUT IN / FECHA	2,8±2,5	-9,5±1,5	3,5±2,5	-8,5±1,5
CUT OUT / ABRE	-1,8±2,5	-16,2±1,5	-1±2,5	-15,5±1,5



09



05

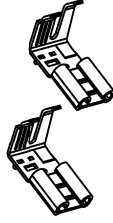

02

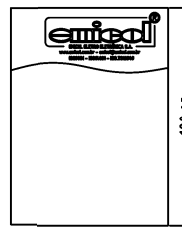

06

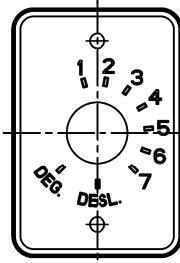

03

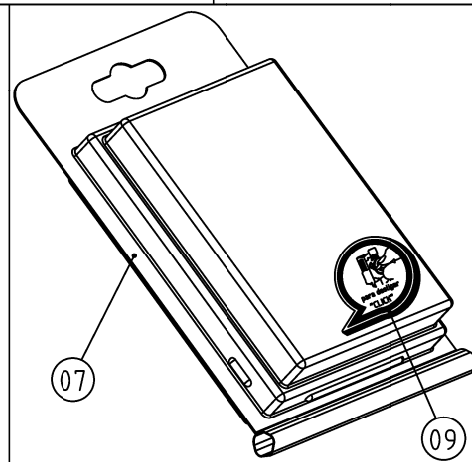

07

09

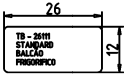

08

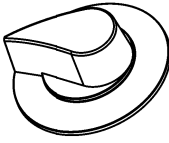

04

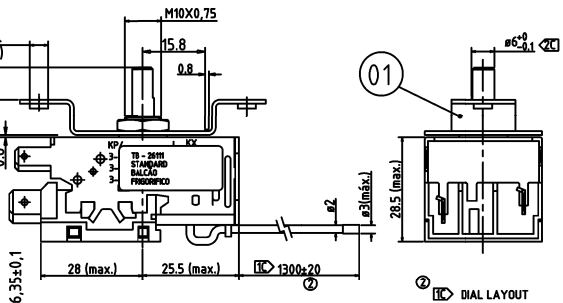
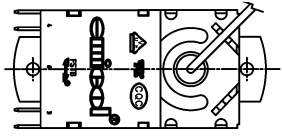
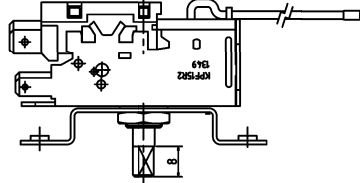

01

DIAL LAYOUT

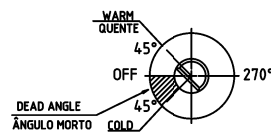

ELECTRICAL DIAGRAM
 DIAGRAMA ELÉTRICO

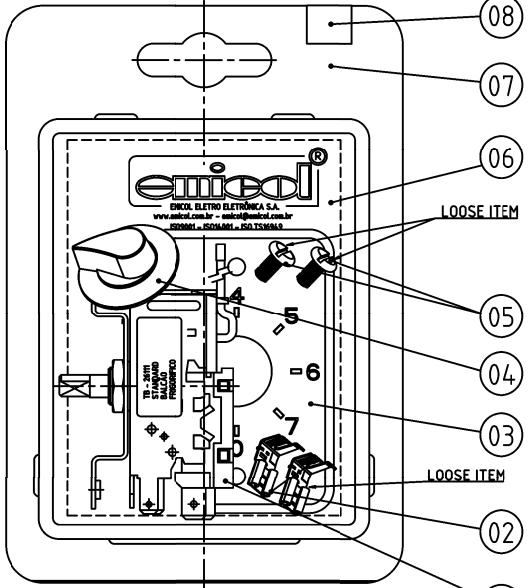
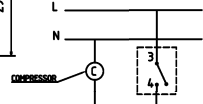

NOTAS:
 1- THE THERMOSTAT CHARGED WITH R134a.
 2- 3-4 MAIN SWITCH CLOSES ON TEMPERATURE RISE
 C: COMPRESSOR.
 3- SWITCH RATE: 3-4-6(6)A 250Vac.
 4- THERMOSTAT SHOWN AT "COLD" POSITION.
 5- THERMOSTAT MUST BE ACCORDING TO THE CURRENT
 ROHS DIRECTIVE.
 6- IP CLASS: IP00.
 7- MAXIMUM EXTERNAL PRESSURE APPLIED TO
 CAPILLARY: 3Mpa.
 ① 8- CAPILLARY BENDING RADIUS GREATER THAN 10mm
 9- CAPILLARY MUST NOT BE BENT WITHIN 40mm TO THE
 BODY.
 ① 10- 150mm(MINIMUM) CAPILLARY ENDING MUST BE IN
 CONTACT WITH THE ENVIRONMENT TO BE CONTROLLED.
 11- DO NOT HANDLE THE THERMOSTAT THROUGH ITS
 CAPILLARY.

NOTAS:
 1- O THERMOSTATO CARREGADO COM R134a
 2- 3-4 CONTATO PRINCIPAL: FECHA QUANDO A
 TEMPERATURA ELEVAR
 3- CONTATOS: 6(6)A 250Vac.
 4- THERMOSTATO MOSTRADO NA POSIÇÃO "FRIO".
 5- THERMOSTATO DEVE ATENDER A NORMA ROHS
 VIGENTE.
 6- CLASSE IP: IP00.
 7- PRESSÃO EXTERNA MÁXIMA APLICADA AO CAPILAR:
 3MPa.
 ① 8- DOBRAS DO CAPILAR DEVEM TER RAIO MAIOR DO QUE
 10mm
 9- CAPILAR NÃO DEVE HAVER DOBRAS EM 40mm A
 PARTIR DO CORPO.
 ① 10- EXTREMIDADE DO CAPILAR (150mm MÍNIMO) DEVE
 ESTAR EM CONTATO COM O MEIO/ COMPONENTE A SER
 CONTROLADO
 11- NÃO MANUSEAR O THERMOSTATO PELO CAPILAR.

09	ADHESIVE LABEL	01
08	ADHESIVE LABEL 26x12	02
07	BLISTER	01
06	EMICOL INFO CARD	01
05	M4x7 SCREW	02
04	KNOB	02
03	DIAL 1	01
02	FLAG TERMINAL 6,3x0,8mm	02
01	THERMOSTAT	01

7										
6										
5										
4										
3										
2	ADDED "TEMP. AT 700mm Hg (°C), AND SPECIAL CHARACTERISTICS, CORRECTED DIMENSION"	16/11/15	FERNANDO	CLAUDIO		SDP: 2009/0391-00				SCALE
1	REDRAWING, CORRECTED THE DRAW AND ADDED NOTES:	24/06/14	FERNANDO	CLAUDIO						1:1

NO. MODIFICATION TYPE DATE: CHECKED BY: APPROVED BY: JTY: 12-PROCESS PROCEDURE 4-APPEARANCE (APARELHO)

DATE: 24/06/14 NAME: BRUNO DESCRIPTION: THERMOSTAT TB - 26111

THIS DRAWING BELONGS TO EMICOL ELETRÔNICA S/A. IT IS FORBIDDEN THE TOTAL OR PARTIAL REPRODUCTION WITHOUT AUTHORIZATION. IF IT IS NOT RESPECTED, IT CAUSES LEGAL PUNISHMENTS.

EMICOL ELETRÔNICA S.A. PART NUMBER: TABLE

DEFAULT TOL: 0.2 UNITS: mm

A2 CAD T2-1701